



NoLimit

SL50 Compact

**MAINTENANCE/SERVICE MANUAL
INSTRUCTION MANUAL**





INDEX

MAINTENANCE / SERVICE MANUAL

1. Foreword
2. Important
3. Warranty Registration
4. Warranty Service Problem
5. New Motorised Buggy Warranty Policy
6. Warranty Exclusions
7. Parts Installed During Warranty
8. Preventative Maintenance Program
9. Cleaning Your SL50 Compact
10. Rear Wheel Axles
11. Clutches
12. Upper & Lower Bag Straps
13. Correcting the Alignment of Your SL50
14. MGI Service Schedule: SL50 Compact
15. Service Record: SL50 Compact

INSTRUCTION MANUAL

1. Most Important points to read prior to using
2. Charging and care of the Battery
3. Fitting the Battery
4. Motor Controller Fuse
5. Attaching / Removing Wheels
6. Folding / Unfolding the Buggy
7. Fitting your Golf Bag
8. Positioning the Seat
9. Assembling the Umbrella Holder
10. Sand Bucket Loop
11. Top Handle – Features
12. Frequently Asked Questions



MAINTENANCE SERVICE MANUAL

1. Foreword

Congratulations on the purchase of your SL50 Compact Buggy.

To ensure continued efficiency of your MGI motorised buggy, regular maintenance at periodic intervals is essential. For guidance, this booklet contains a schedule applicable to the maintenance required at the appropriate times and a service record.

2. Important

If operating in conditions such as those mentioned below, speed controls, clutches, frame alignment, adjustment, tightening and axle alignment should be serviced at more frequent intervals than specified in this booklet:

- a. playing more than twice a week
- b. damp or wet conditions
- c. rough, dusty or sandy conditions
- d. hilly conditions

3. Warranty Registration

Warranty registration can be made either on-line or using the warranty registration card supplied with your motorised buggy. It must be completed and returned to MGI within 14 days of purchase.

4. Warranty Service Problem

Purchase date of the motorised buggy must be given before warranty is accepted for processing. In the event of a need for warranty service, either refer to the list of authorised service centres or call MGI on 1300 644 523

5. New Motorised Buggy Warranty Policy

MGI warrants in respect of each new MGI SL50 motorised buggy sold, that for a period of twelve months, from the date of purchase, MGI or an authorised dealer will repair or replace free of charge any parts found to be defective in materials or workmanship under normal use provided that:

- a. The motorised buggy has been properly and reasonably used, maintained and regularly serviced.
- b. The replacement or repair is performed by an authorised MGI service centre.



6. Warranty Exclusions:

- a. Any defect caused by misuse, negligence, accident or failure to carry out proper maintenance procedures.
- b. Any alteration performed by non authorised people or companies.
- c. Fitting of parts or accessories not recommended by MGI.
- d. Any damage caused by continued operation of the motorised buggy after it is known to be defective.
- e. Bent seat support bracket on buggy chassis

All implied warranties [save those preserved by statute] are excluded. Liability for consequential damages under any and all warranties are excluded to the extent exclusion is permitted by law.

7. Parts Installed During Warranty

Warranty coverage for components installed during a motorised buggy's warranty period shall consist of the duration of the buggy's warranty period, provided the warranty installation is performed by MGI, an authorised service centre or the buggy owner on approval.

PLEASE NOTE: Due to MGI's on going commitment to product improvement, MGI reserves the right to change at any time, product specification, configurations and company policies.

8. Preventative Maintenance Program

To properly provide for the continued operation of your motorised buggy, MGI has introduced its Preventative Maintenance Program [PMP]. The PMP consists of work to be carried out by both the owner and authorised service centres. To properly maintain the warranty of your MGI SL50, it is essential that this work is carried out. If the work carried out by the authorised service centre is to replace parts that are part of the maintenance schedule, the owner will be charged for the parts and labour. If the work to be carried out is part of warranty, MGI will bear the cost.

9. Cleaning Your SL50 Compact [See Maintenance Schedule]

For years of good operation, your buggy requires care and attention. Keep your buggy clean using a cloth with warm water and a mild detergent. Do not hose down your buggy under any circumstance, as your buggy has electronic components. Ensure that the seat stem bracket and sand bucket loop bracket plastic inserts are cleaned to remove dirt and sand.



10. Rear Wheel Axles [See Maintenance Schedule]

The rear wheel stub axles need to be lubricated regularly. Remove the rear wheels by depressing the spring clip and at the same time pull off the wheel. Apply Petroleum Jelly or light grease to the stub axles. Use a very small amount as the grease can attract sand. If you play in sandy conditions you should clean your axle and regrease fortnightly.

To refit the rear wheels you will need to align the wheel's four sided slot to its equivalent on the buggy to ensure the wheels are properly engaged. Ensure that the wheels are put on the correct side 'L' and 'R'.

11. Clutches [See Maintenance Schedule]

The rear wheel clutches need to be cleaned and checked to confirm they function correctly. Remove the rear wheels by depressing the spring clip and at the same time pull off the wheel. The clutches can then be removed by pulling them off the axle.

If you play in sandy conditions you should clean your clutches every three months. Clean the clutches by immersing them in kerosene to remove the sand and grit. Then apply a small amount of Petroleum Jelly or light grease inside of the clutch.

Place the clutches back on the axles to check that they function correctly. Try and turn the Right Hand clutch in an anti clock wise direction – if you cannot it is functioning correctly. Try and turn the Left Hand clutch in a clock wise direction – if you cannot it is functioning correctly.

12. Upper & Lower Bag Straps [See Maintenance Schedule]

The upper and lower bag straps should be replaced as per the Service Schedule on page 5. They can be replaced by:

1. Removing male section of clip from bag strap
2. Unthreading old strap from bag support
3. Threading new strap into bag support from left hand side, looking from the rear of the buggy
4. Inserting new male clip on to bag strap

13. Correcting the Alignment of your SL50 [See Maintenance Schedule]



If during use, you find that the buggy veers to the right or left, please follow the instructions below to correct this problem:

1. If the buggy veers to the left, face the front wheel of the buggy and use the Allen key provided to screw the right bolt clockwise or the left bolt anti-clockwise.
2. If the buggy veers to the right, face the front wheel of the buggy and use the Allen key provided to screw the left bolt clockwise or the right bolt anti clockwise.

Test run the buggy and repeat the process until the buggy runs straight.



14. MGI Service Schedule: SL50 Compact

It is the owner's responsibility to ensure that all periodical checks, necessary adjustments and services are carried out. If in doubt please contact the MGI service centre on 1300 644 523. Any work performed on your buggy should be recorded on your service record (see page 7) regardless of the work.

	Monthly	Six Monthly	Yearly	Three Yearly
Wipe down the buggy with warm cloth after each use – see page 5 point 9				
Lubricate rear wheel stub axles – see page 5 point 10	BO			
Clean and then lubricate clutches with-see page 5 point 11		BO		
Check rear wheel clutches function correctly – see page 5 point 11		BO		
Check and tighten all nuts and bolts		BO/SC		
Check and tighten handle pivots		BO/SC		
Check alignment of buggy - ensure that it runs straight – see page 5 point 13		BO/SC		
Check alignment and operation of gearbox and axle(s)			SC	
Replace handle grips			BO/SC	
Replace rear axle support bearing housings			SC	
Replace rear wheel clutches			BO/SC	
Replace rear wheel spring latches			BO/SC	
Replace rear wheel drive hubs			BO/SC	
Replace seat bracket & sand bucket loop plastic inserts			BO/SC	
Replace battery leads			BO/SC	
Replace speed controller and On / Off switch assembly			BO/SC	
Replace rear and front wheels – see page 10 point 5				BO
Replace Upper & Lower Bag Straps – see page 5 point 12				BO

BO = Buggy owner can carry out this work

SC = Charged work to be carried by approved service centre

BO/SC = The six monthly service can be completed by either an authorised service centre or the owner of the buggy. The tools to tighten all nuts and bolts are provided with your maintenance / service and instruction manual. As part of MGI's Preventative Maintenance Program, if the six monthly services are carried out by an authorised service centre, you will be charged for that service.

It is important for your warranty and the life of your buggy that the service record be observed and maintained.



15. Service Record: SL50 Compact

SIX MONTH INSPECTION	DATE: .	SERVICED BY:
	INVOICE NO:	SIGNATURE:
ONE YEAR INSPECTION	DATE: .	SERVICED BY:
	INVOICE NO:	SIGNATURE:
1½ YEAR INSPECTION	DATE: .	SERVICED BY:
	INVOICE NO:	SIGNATURE:
TWO YEAR INSPECTION	DATE: .	SERVICED BY:
	INVOICE NO:	SIGNATURE:
2½ YEAR INSPECTION	DATE: .	SERVICED BY:
	INVOICE NO:	SIGNATURE:
THREE YEAR INSPECTION	DATE: .	SERVICED BY:
	INVOICE NO:	SIGNATURE:
3½ YEAR INSPECTION	DATE: .	SERVICED BY:
	INVOICE NO:	SIGNATURE:
FOUR YEAR INSPECTION	DATE: .	SERVICED BY:
	INVOICE NO:	SIGNATURE:
4½ YEAR INSPECTION	DATE: .	SERVICED BY:
	INVOICE NO:	SIGNATURE:
FIVE YEAR INSPECTION	DATE: .	SERVICED BY:
	INVOICE NO:	SIGNATURE:
5½ YEAR INSPECTION	DATE: .	SERVICED BY:
	INVOICE NO:	SIGNATURE:
SIX YEAR INSPECTION	DATE: .	SERVICED BY:
	INVOICE NO:	SIGNATURE:
ADDITIONAL SERVICE	DATE: .	SERVICED BY:
	INVOICE NO:	SIGNATURE:
ADDITIONAL SERVICE	DATE: .	SERVICED BY:
	INVOICE NO:	SIGNATURE:
ADDITIONAL SERVICE	DATE: .	SERVICED BY:
	INVOICE NO:	SIGNATURE:
ADDITIONAL SERVICE	DATE: .	SERVICED BY:
	INVOICE NO:	SIGNATURE:

Additional Service – this is to record any servicing outside the normal schedule.



INSTRUCTION MANUAL

1. Most Important points to read prior to using

- a. Register your buggy either on line – www.mgikaddy.com – or by completing the enclosed warranty card
- b. Charge the battery
- c. Assemble the buggy placing the rear wheels on their correct side

2. Charging and care of the battery

- a. Prior to the **first** and after **every** use charge the Battery. The battery and charger comes with an easy connection system. Red to Red and Black to Black.
Important: - The battery must be charged at least over night before its first use.



- b. Your battery is designed for 18 holes only. If you play more than 18 holes before recharging, the battery's life could be compromised.
- c. Always recharge the battery as soon as possible after use, no matter how short the period of use. Your battery will charge best, lying flat, in a warm and air flowing location.
Note: In winter, it is best charged off any concrete floor and preferably in a warm location within the house.
- d. During play, minimise the drain on the battery by avoiding taking your buggy into the rough whenever possible.
- e. Avoid as much as possible using the buggy to pull you up the hills.
- f. In between use, always leave the charger connected to the battery with power on.
- g. If you are not playing golf for sometime, you may disconnect the battery once it is charged. The battery will need recharging at least every 3 months and must be recharged prior to use. The battery should be stored in a dry and warm environment.
- h. The battery is a sealed battery. If you are intending to take your buggy and battery on air travel, we advise that you make contact with your airline prior to travel.
- i. Be very careful not to drop your battery. The battery casing is easily cracked and the battery's subsequent life will be severely compromised.



3. Fitting the battery

Once charged, the battery can be fitted to the buggy. The battery comes with a battery cover, carry handle and battery leads.

- a. Place your battery in the tray with the leads facing to the front of the buggy.
- b. The battery tray has a battery securing strap.
- c. The securing strap is to be used at all times as it protects your battery against damage from falling out.
- d. The battery lead can now be connected to the battery tray. Connect red to red and black to black.



4. Motor Controller Fuse

Your SL50 compact has a 30 amp fuse connected to the motor controller. The 30-amp fuse helps protect the buggy's control board against a power surge.

An extra fuse is supplied with your buggy.

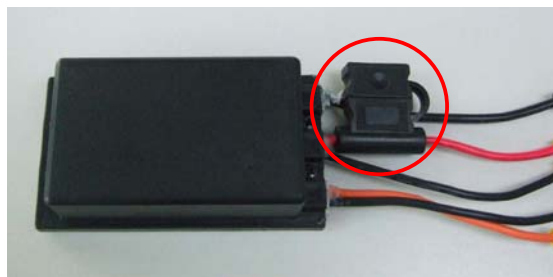

In the unlikely event of your buggy stopping, the reason could be the fuse has blown. Check and replace if necessary.

The replacement of the fuse will allow you to continue using your buggy. If the fuse blows, contact your service centre.



5. Attaching / Removing Wheels

If your buggy comes with the rear wheels off, they should be placed in position prior to unfolding. You will need to put the rear wheels on the correct sides. The rear wheels are marked 'L' and 'R' on the inside of the hub. The left and right of the buggy are determined by looking from the rear of the buggy. You will need to align the four slots on the inside of the rear wheel with the same four on the clutch on the axle. To engage the rear wheel, depress the quick release catch until the wheel is in place.



The SL50 uses a free wheeling gear system. This means that drive will only occur when the speed control is turned on. If for some reason your buggy stops operating during your golf round, your buggy can free wheel by pushing the buggy forward.

Also as a free wheeling buggy, it is important that when the buggy is stopped, the buggy is positioned so that it cannot roll forward. The SL50 will not easily roll backwards.

If your buggy comes with the front wheel off, it should be placed in position prior to unfolding. The following steps will need to be taken:

1. In its folded down position, carefully turn the buggy upside down
2. Place the front wheel assembly into its housing with the indent on the arm facing towards you.
3. Insert the front wheel assembly fully into its housing
4. Secure the front wheel assembly by moving the securing latch over towards the rear of the buggy.

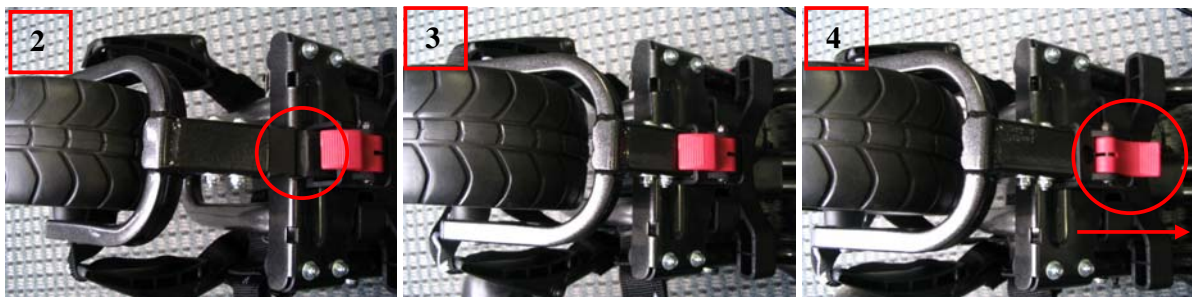



6. Folding / unfolding your buggy

Practice unfolding and folding the buggy using the steps below. This means when you go to play golf you will be somewhat familiar with this task.

1. Release the handle locking mechanism in the centre of the handle
2. Collapse the handle by pushing it forward
3. Lock the handle
4. Bend your knees and lift the buggy using the bottom bag support lifting handle and top handle piece



Step 1



Step 2



Step 4

The following order of steps is suggested when folding your buggy down:

1. Seat and stem off first.
2. Golf bag off second.
3. Battery off and directly into the boot of the car. This will save double handling.
4. Sand bucket and loop off.
5. Fold down buggy as per above and place into the boot of the car.



17. Fitting your Golf Bag

1. Separate the clip located on the top and bottom bag supports.
2. Expand the strap to be enough to fit around the golf bag.
3. Place your golf bag on the buggy.
4. Clip the top and bottom bag support straps in place.
5. Pull the top and bottom bag support straps tight.





18. Positioning the Seat

The SL50 comes with two seat positions, one of either side of the buggy. Choose which ever side that suits you and place the seat stem into its position in the seat stem bracket.

MOST IMPORTANT: DEPRESS THE SEAT WITH YOUR HAND BEFORE SITTING. DO NOT USE THE SEAT ON UNEVEN SURFACES.

Please note MGI does not warrant any seat support brackets that are damaged or bent.



19. Assembling the Umbrella Holder



Your buggy comes with an umbrella holder. The umbrella holder needs to be bolted into position. Simply follow the pictures above. When not in use the umbrella holder can be turned to its side. If you take your buggy home in your car, you may need to do that prior to folding the buggy down. Your umbrella holder can be adjusted both to the side and backwards and forwards.

The umbrella is secured inside the umbrella holder by tightening the plastic bolt located near the top of the holder.

DO NOT LEAVE YOUR UMBRELLA UP IN THE UMBRELLA HOLDER IN WINDY CONDITIONS.

If the wind catches the umbrella, it could cause your buggy to tip over and cause damage, which will not be covered by warranty.



20. Sand Bucket Loop

The SL50 comes with two seat positions, one of either side of the buggy. Choose which ever side suits you and place the sand bucket loop into its position in the spare position on the opposite side.



21. Top Handle Features



a. Control Assembly

On/Off Switch – this is a toggle switch and is in the “On” position when the light is on.

Speed Control – this has a rotating knob. The speed control is designed for the slow take off. This ensures that the SL50 will not advance quickly leaving you behind.

To turn the buggy on, the On/Off is to be put in the “On” position. By rotating the speed control clockwise, the buggy will move forward. Rotate until the desired speed is obtained.

The buggy can be stopped by using either the “On/Off” switch or the speed control can be turned anti-clockwise until the buggy stops [you will hear the switch click off].

b. Scorecard holder and compartment

There is a position for your scorecard on the flap of the top handle. Under the flap there is a storage compartment that holds pencils, divot repair tools and other small items.

c. Drink bottle holder

There is a drink bottle holder located on the top handle.

d. Golf ball and tee holders

There is provision to hold two golf balls and four “tees” on the top handle.



26. Frequently Asked Questions and Answers:

Question: Is it important to register my purchase for warranty purposes?
Answer: You must register your purchase as soon as possible with MGI. You can register on line or through the mail. The serial number for your buggy is located underneath the top handle scorecard compartment.

Question: How often should my battery be charged?
Answer: Your battery should be left on charge in between use. You should put your used battery back on charge as soon as possible. Leaving your battery in a discharged state will shorten its life.

Question: Should I discharge my battery fully to remove memory?
Answer: NO – Gel batteries do not have memory issues. Fully discharging the battery will damage it and the charger will not be able to recharge the battery.

Question: Where can I take my buggy to be serviced?
Answer: There are 80 service centres across Australia - please check out our website www.mgikaddy.com for an up to date listing or contact us on 03 9873 4433 or 1300 644 523.

In Melbourne you can also bring your buggy to our main service centre at head office at 11 Maurice Court Nunawading (Melways Ref: Map 48 H11).
In the Melbourne & Sydney areas, there are mobile service vans that attend most golf courses and retailers.

MGI invests large amounts of capital into advancing the mechanical and electronic features of its range of buggies. Should you have any positive feedback or suggestion, which would further enhance the performance of our buggies, we would welcome your correspondence.

If you have any concerns relating to the use of your motorised golf buggy do not hesitate to call us at 1300 644 523. Thank you for your assistance and continued support.

Most importantly please provide us with your email address so that we can forward to you technical updates and other information. Please email MGI on sales@mgikaddy.com